

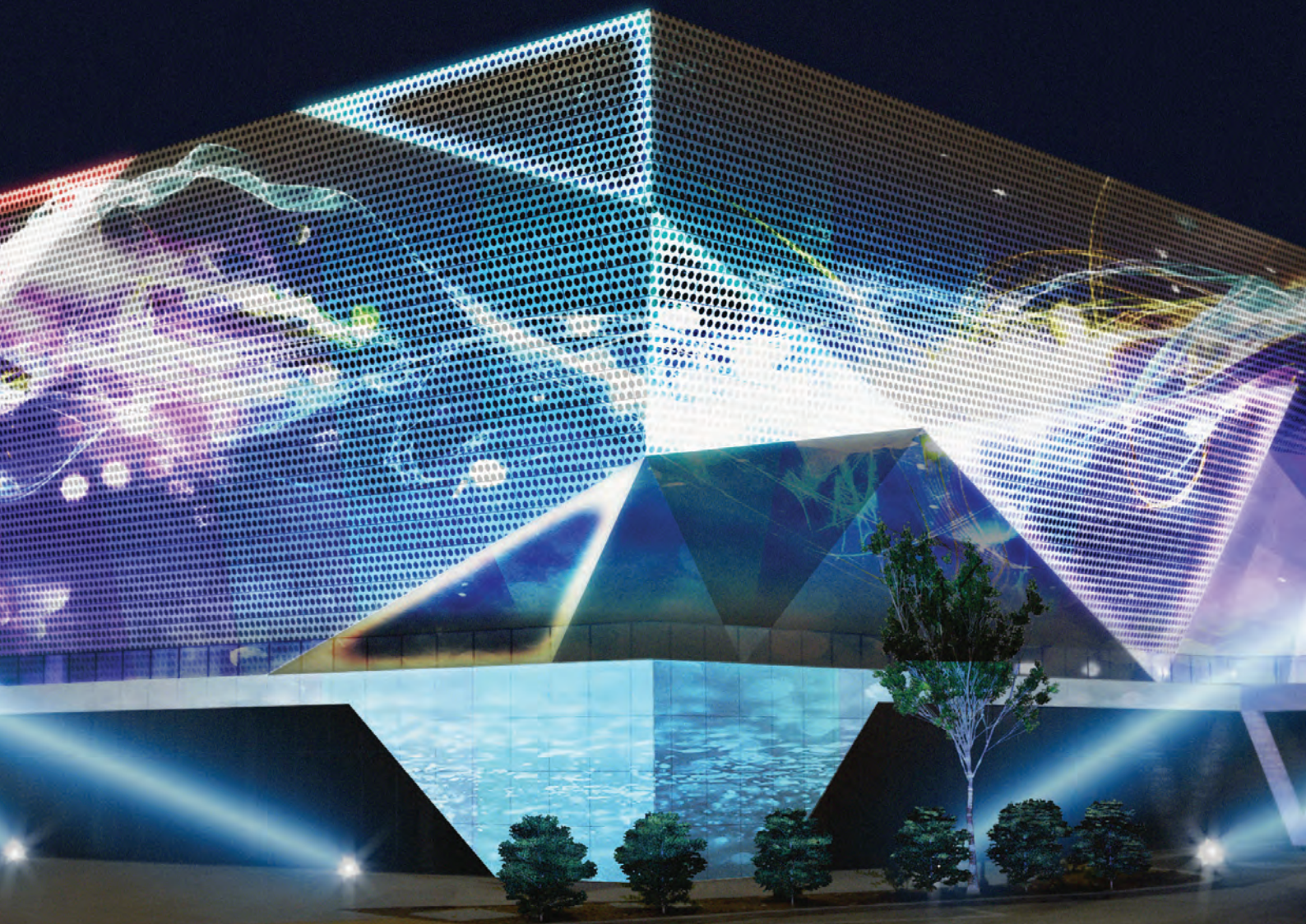





EPSON
EXCEED YOUR VISION

PROJECTOR RANGE GUIDE



ENTRY BUSINESS

Note: Highlighted boxes indicate step-ups between models / within series						
Product Code	V11H976053	V11HA02053	V11H978053	V11H986053	V11H987053	V11H988053
IMAGE						
Light Source	Lamp	Lamp	Lamp	Lamp	Lamp	Lamp
Resolution	XGA	WXGA	1080p	XGA	WXGA	1080p
Colour Light Output	3,800 lm	4,000 lm	4,000 lm	4,100 lm	4,200 lm	4,000 lm
White Light Output	3,800 lm	4,000 lm	4,000 lm	4,100 lm	4,200 lm	4,000 lm
Native Aspect Ratio	4:3	16:10	16:9	4:3	16:10	16:9
Contrast Ratio	16,000:1	16,000:1	16,000:1	16,000:1	16,000:1	16,000:1
Lamp Type	210 W UHE	210 W UHE	230 W UHE	230 W UHE	230 W UHE	230 W UHE
Keystone Correction (Standard Lens)	Vertical: ±30° Horizontal: ±30°	Vertical: ±30° Horizontal: ±30°	Vertical: ±30° Horizontal: ±30°	Vertical: ±30° Horizontal: ±30°	Vertical: ±30° Horizontal: ±30°	Vertical: ±30° Horizontal: ±30°
OPTICAL (for Standard Lens)						
Zoom	1 – 1.2 (Optical)	1 – 1.2 (Optical)	1 – 1.6 (Optical)	1 – 1.6 (Optical)	1 – 1.6 (Optical)	1 – 1.6 (Optical)
Screen Size	30" to 300"	33" to 320"	30" to 300"	27" to 262"	29" to 280"	30" to 300"
Projection Distance	60" screen 1.8 m – 2.17 m	60" screen 1.68 m – 2.02 m	60" screen 1.76 m – 2.86 m	60" screen 1.93 m – 3.14 m	60" screen 1.79 m – 2.92 m	60" screen 1.76 m – 2.86 m
Throw Ratio	1.48 (Zoom: Wide) 1.77 (Zoom: Tele)	1.30 (Zoom: Wide) 1.56 (Zoom: Tele)	1.32 (Zoom: Wide) 2.14 (Zoom: Tele)	1.58 (Zoom: Wide) 2.56 (Zoom: Tele)	1.38 (Zoom: Wide) 2.24 (Zoom: Tele)	1.32 (Zoom: Wide) 2.14 (Zoom: Tele)
Focus Method	Manual	Manual	Manual	Manual	Manual	Manual
CONNECTIVITY						
Input: Video	1 x RCA (Yellow)	1 x RCA (Yellow)	1 x RCA (Yellow)	1 x RCA (Yellow)	1 x RCA (Yellow)	1 x RCA (Yellow)
Input: Computer	1 x D-sub 15-Pin (RGB), 1 x USB 2.0 type B	1 x D-sub 15-Pin (RGB), 1 x USB 2.0 type B	1 x D-sub 15-Pin (RGB), 1 x USB 2.0 type B	2 x D-sub 15-Pin (RGB), 1 x USB 2.0 type B	2 x D-sub 15-Pin (RGB), 1 x USB 2.0 type B	2 x D-sub 15-Pin (RGB), 1 x USB 2.0 type B
Input: Digital	1 x HDMI	1 x HDMI	2 x HDMI	2 x HDMI	2 x HDMI	2 x HDMI
Input: Audio	1 x RCA (Red / White)	1 x RCA (Red / White)	1 x RCA (Red / White)	1 x RCA (Red / White), 2 x Stereo mini	1 x RCA (Red / White), 2 x Stereo mini	1 x RCA (Red / White), 2 x Stereo mini
Control: I / O	-	-	-	1 x RS232C	1 x RS232C	1 x RS232C
Network: I / O	1 x USB 2.0 type A (for Optional Wireless LAN)	1 x USB 2.0 type A	1 x USB 2.0 type A	1 x RJ45, 1 x USB 2.0 type A (for Optional Wireless LAN)	1 x RJ45, 1 x USB 2.0 type A (for Optional Wireless LAN)	1 x RJ45, 1 x USB 2.0 type A
Wireless Connectivity	Optional	Included	Included	Optional	Optional	Included
Output: Video	-	-	-	1 x D-sub 15 pin	1 x D-sub 15 pin	1 x D-sub 15 pin
Output: Audio	-	-	-	1 x Stereo mini	1 x Stereo mini	1 x Stereo mini
ADVANCED FEATURES						
Built-in Speaker	2 W	2 W	16 W	16 W	16 W	16 W
Epson Projector Management (Network & Control)	Yes	Yes	Yes	Yes	Yes	Yes
Epson iProjection (Multi-PC Projection)	Yes	Yes	Yes	Yes	Yes	Yes
Wireless LAN Enterprise Security	-	-	Yes	-	-	Yes
Miracast	-	-	Yes	-	-	Yes
Split Screen	Yes	Yes	Yes	Yes	Yes	Yes
Auto Keystone Correction	Vertical: ±30°	Vertical: ±30°	Vertical: ±30°	Vertical: ±30°	Vertical: ±30°	Vertical: ±30°
Horizontal Slide Keystone Correction	Yes	Yes	Yes	Yes	Yes	Yes
Instant Off	Yes	Yes	Yes	Yes	Yes	Yes
Direct Power On	Yes	Yes	Yes	Yes	Yes	Yes
Security	Kensington – style lock provision, Password protect function					
Colour Modes	Dynamic, Presentation, Cinema, sRGB, Blackboard					
GENERAL						
Dimensions D x W x H (Including feet)	237 x 302 x 82 mm	237 x 302 x 92 mm	293 x 309 x 105 mm	293 x 309 x 105 mm	293 x 309 x 105 mm	293 x 309 x 105 mm
Weight	2.5 kg	2.6 kg	3.1 kg	3.1 kg	3.1 kg	3.1 kg
Lamp Life (Normal / Eco)	6,000 h / 12,000 h	6,000 h / 12,000 h	5,500 h / 12,000 h	6,500 h / 17,000 h	6,500 h / 17,000 h	6,500 h / 17,000 h
Power Consumption: Lamp On	327 W	327 W	327 W	327 W	327 W	327 W
Power Consumption: Standby	2.0 W	2.0 W	2.0 W	2.0 W	2.0 W	2.0 W
Noise Level (Normal / Eco)	37 / 28 dB	37 / 28 dB	37 / 28 dB	37 / 28 dB	37 / 28 dB	37 / 28 dB

	PORTABLE BUSINESS		MID-RANGE BUSINESS		
Note: Highlighted boxes indicate step-ups between models / within series					
	EB-1780W	EB-1795F	EB-L200F	EB-2250U	EB-2265U
Product Code	V11H795053	V11H796053	V11H990053	V11H871053	V11H814053
IMAGE					
Light Source	Lamp	Lamp	Laser Diode	Lamp	Lamp
Resolution	WXGA	1080p	Full HD*	WUXGA	WUXGA
Colour Light Output	3,000 lm	3,200 lm	4,500 lm	5,000 lm	5,500 lm
White Light Output	3,000 lm	3,200 lm	4,500 lm	5,000 lm	5,500 lm
Native Aspect Ratio	16:10	16:9	16:9	16:10	16:10
Contrast Ratio	10,000:1	10,000:1	2,500,000:1	15,000:1	15,000:1
Lamp Type	206 W UHE	214 W UHE	Laser	300 W UHE	300 W UHE
Keystone Correction (Standard Lens)	Vertical: $\pm 45^\circ$ / Horizontal: $\pm 30^\circ$	Vertical: $\pm 45^\circ$ / Horizontal: $\pm 30^\circ$	Vertical: $\pm 30^\circ$ / Horizontal: $\pm 30^\circ$	Vertical: $\pm 30^\circ$ / Horizontal: $\pm 30^\circ$	Vertical: $\pm 30^\circ$ / Horizontal: $\pm 30^\circ$
OPTICAL (for Standard Lens)					
Zoom	1 – 1.2 (Optical)	1 – 1.2 (Optical)	1 – 1.6 (Optical)	1 – 1.6 (Optical)	1 – 1.6 (Optical)
Screen Size	30" to 300"	30" to 300"	40" to 500"	50" to 300"	50" to 300"
Projection Distance	60" screen 1.35 m – 1.62 m	60" screen 1.35 m – 1.64 m	60" screen 1.72 m	80" screen 2.36 m – 3.92 m	80" screen 2.36 m – 3.92 m
Throw Ratio	1.04 (Zoom: Wide) 1.26 (Zoom: Tele)	1.02 (Zoom: Wide) 1.23 (Zoom: Tele)	1.33 (Zoom: Wide) 2.16 (Zoom: Tele)	1.38 (Zoom: Wide) 2.28 (Zoom: Tele)	1.38 (Zoom: Wide) 2.28 (Zoom: Tele)
Focus Method	Manual	Powered	Manual	Manual	Manual
CONNECTIVITY					
Input: Video	1 x RCA (Yellow)	1 x RCA (Yellow)	1 x RCA (Yellow)	1 x RCA (Yellow)	1 x RCA (Yellow)
Input: Computer	1 x D-sub 15-Pin (RGB), 1 x USB 2.0 type B		2 x D-sub 15-Pin (RGB), 1 x USB 2.0 type B		
Input: Digital	1 x HDMI (1 x MHL)	1 x HDMI (1 x MHL)	2 x HDMI	2 x HDMI (1 x MHL)	2 x HDMI (1 x MHL), 1 x HDBaseT
Input: Audio	1 x Stereo mini	1 x Stereo mini	1 x RCA (Red / White), 2 x Stereo mini	1 x RCA (Red / White), 2 x Stereo mini	
Control: I / O	1 x USB 2.0 type B	1 x USB 2.0 type B	1 x USB 2.0 type B, 1 x RS232C		
Network: I / O	1 x USB 2.0 type A	1 x USB 2.0 type A	1 x RJ45, 1 x USB 2.0 type A	1 x RJ45, 1 x USB 2.0 type A (for Optional Wireless LAN)	1 x RJ45, 1 x USB 2.0 type A
HDBaseT	-	-	-	-	Yes
Wireless Connectivity	Included	Included	Included	Optional	Included
Output: Video	-	-	1 x D-sub 15 pin (RGB)	1 x D-sub 15 pin (RGB)	1 x D-sub 15 pin (RGB)
Output: Audio	-	-	1 x Stereo mini	1 x Stereo mini	1 x Stereo mini
ADVANCED FEATURES					
Built-in Speaker	1 W	1 W	16 W	16 W	16 W
Epson Projector Management (Network & Control)	Yes	Yes	Yes	Yes	Yes
Epson iProjection (Multi-PC Projection)	Yes	Yes	Yes	Yes	Yes
Miracast	-	Yes	Yes	-	Yes
Split Screen	Yes	Yes	Yes	Yes	Yes
Auto Keystone Correction	Vertical: $\pm 30^\circ$	Vertical: $\pm 30^\circ$	Vertical: $\pm 30^\circ$ / Horizontal: $\pm 30^\circ$	Vertical: $\pm 30^\circ$ / Horizontal: $\pm 20^\circ$	Vertical: $\pm 30^\circ$ / Horizontal: $\pm 20^\circ$
Gesture Presenter	-	Yes	-	Yes	Yes
NFC (Near Field Communication)	-	Yes	-	-	-
Screen Fit	-	Yes	-	Yes	Yes
Instant Off	Yes	Yes	Yes	Yes	Yes
Direct Power On	Yes	Yes	Yes	Yes	Yes
Security	Kensington® – style lock provision, Password protect function		Padlock & Security cable hole, Kensington® – style lock provision, Wireless LAN unit lock, Password protect function		
Colour Modes	Dynamic, Presentation, Cinema, sRGB, Blackboard, DICOM SIM				
GENERAL					
Dimensions D x W x H (Including feet)	213 x 292 x 53 mm	213 x 292 x 53 mm	299 x 325 x 105 mm	291 x 377 x 110 mm	291 x 377 x 110 mm
Weight	1.8 kg	1.8 kg	4.1 kg	4.8 kg	4.9 kg
Lamp Life (Normal / Eco)	4,000 h / 7,000 h	4,000 h / 7,000 h	-	5,000 h / 10,000 h	5,000 h / 10,000 h
Power Consumption: Lamp On	277 W	295 W	254 W	420 W	450 W
Power Consumption: Standby	2.0 W	2.0 W	2.0 W	2.0 W	2.0 W
Noise Level (Normal / Eco)	39 / 30 dB	39 / 30 dB	36 / 27 dB	39 / 29 dB	39 / 29 dB

SHORT THROW

ULTRA SHORT THROW

Note: Highlighted boxes indicate step-ups between models / within series



EB-L200SW



EB-685W



EB-735F



EB-805F

Product Code	V11H993053	V11H744553	V11HA00553	V11H923653
--------------	------------	------------	------------	------------

IMAGE

Light Source	Laser Diode	Lamp	Laser Diode	Laser Diode
Resolution	WXGA	WXGA	1080p	Full HD*
Colour Light Output	3,800 lm	3,500 lm	3,600 lm	5,000 lm
White Light Output	3,800 lm	3,500 lm	3,600 lm	5,000 lm
Native Aspect Ratio	16:10	16:10	16:9 up to 120" / 16:6 up to 110"	16:9 up to 130" / 16:6 up to 120"
Contrast Ratio	2,500,000:1	14,000:1	2,500,000:1	2,500,000:1
Lamp Type	Laser	250 W UHE	Laser	Laser
Keystone Correction (Standard Lens)	Vertical: ±15° Horizontal: ±15°	Vertical: ±3° Horizontal: ±3°	Vertical: ±3° Horizontal: ±3°	Vertical: ±3° Horizontal: ±3°

OPTICAL (for Standard Lens)

Zoom	1 – 1.35 (Digital)	1 – 1.35 (Digital)	1 – 1.35 (Digital)	1 – 1.35 (Digital)
Screen Size	53" to 120"	60" to 100"	65" to 120" @ 16:9 60" to 110" @ 16:6	65" to 130" @ 16:9 61" to 120" @ 16:6
Projection Distance	87" screen 0.91 m	74.3" screen 0.44 m	76" screen at 44.3 cm	96" screen 80.3 cm
Throw Ratio	0.48 (Zoom: Wide) / 0.65 (Zoom: Tele)	0.28 (Zoom: Wide) / 0.37 (Zoom: Tele)	0.26 (Zoom: Wide) / 0.36 (Zoom: Tele)	0.27 (Zoom: Wide) / 0.37 (Zoom: Tele)
Focus Method	Manual	Manual	Manual	Manual

CONNECTIVITY

Input: Video	1 x RCA (Yellow)	1 x RCA (Yellow)	1 x RCA (Yellow)	1 x RCA (Yellow)
Input: Computer	2 x D-sub 15-Pin (RGB), 1 x USB 2.0 type B			
Input: Digital	2 x HDMI	3 x HDMI (1 x MHL)	3 x HDMI	3 x HDMI
Input: Audio	1 x RCA (Red / White), 2 x Stereo mini, 1 x Mic	3 x Stereo mini, 1 x Mic-in Stereo Mini	3 x Stereo mini 1 x Mic-In Stereo Mini	3 x Stereo Mini
Control: I / O	1 x RS-232C D-sub 9pin	1 x RS-232C D-sub 9pin	1 x RS-232C (D-sub 9 pin)	1 x RS-232C D-sub 9pin
Network: I / O	1 x RJ45, 1 x USB Type A (for Optional Wireless LAN)		1 x RJ45, 1 x USB Type A	1 x RJ45, 2 x USB Type A (for Optional Wireless LAN)
HDBaseT	-	-	-	Yes
Wireless Connectivity	Included	Optional	Included	Optional
Output: Video	1 x D-sub 15 Pin (RGB)	1 x RGB D-sub 15pin	1 x RGB D-sub 15pin	1 x D-sub 15pin (RGB), 1 x HDMI
Output: Audio	1 x Stereo mini	1 x Stereo mini	1 x Stereo mini	1 x Stereo Mini

ADVANCED FEATURES

Built-in Speaker	16 W	16 W	16 W	16 W
Epson Projector Management (Network & Control)	Yes	Yes	Yes	Yes
Epson iProjection (Multi-PC Projection)	Yes	Yes	Yes	Yes
Wireless LAN	Yes	Yes (with Optional Wireless LAN Unit)	Yes	Yes (with Optional Wireless LAN Unit)
Split Screen	Yes	Yes	Yes	Yes
Content Playback	Yes	-	-	-
Edgeblending	Yes	-	-	Yes
Instant Off	Yes	Yes	Yes	Yes
Direct Power On	Yes	Yes	Yes	Yes
Security	Kensington®-style lock provision, Padlock Security cable hole, Password protect function	Kensington® – style lock provision, Padlock Security cable hole, Wireless LAN unit lock, Password protect function		
Colour Modes	Dynamic, Presentation, Cinema, sRGB, Blackboard, Multi-Projection	Dynamic, Presentation, Cinema, sRGB, Blackboard		

GENERAL

Dimensions D x W x H (Including Feet)	337 x 325 x 131 mm	400 x 367 x 187 mm	395 x 357 x 162 mm	450 x 458 x 227.5 mm
Weight	4.5 kg	5.7 kg	5.7 kg	9.4 kg
Lamp Life (Normal / Eco)	-	5,000 h / 10,000 h	-	-
Power Consumption: Lamp / LD On	254 W	354 W	255 W	366 W
Power Consumption: Standby	2.0 W	2.3 W	2.0 W	2.0 W
Noise Level (Normal / Eco)	36 / 26 dB	35 / 30 dB	36 / 26 dB	36 / 27 dB
Projector Wall Mount	Optional (ELPMB64)	Optional (ELPMB62)	Optional (ELPMB62)	Optional (ELPMB62)

INTERACTIVE ULTRA SHORT THROW

Note: Highlighted boxes indicate step-ups between models / within series



EB-725Wi

EB-735Fi

EB-1480Fi

EB-1485Fi

Product Code	V11H998553	V11H997553	V11H921553	V11H919053
--------------	-------------------	-------------------	-------------------	-------------------

IMAGE

Light Source	Laser Diode	Laser Diode	Laser Diode	Laser Diode
Resolution	WXGA	1080p	Full HD*	Full HD*
Colour Light Output	4,000 lm	3,600 lm	5,000 lm	5,000 lm
White Light Output	4,000 lm	3,600 lm	5,000 lm	5,000 lm
Native Aspect Ratio	16:10 up to 100"	16:9 up to 100" 16:6 up to 110"	16:9 up to 100"	16:9 up to 100" 16:6 up to 120"
Contrast Ratio	2,500,000:1	2,500,000:1	2,500,000:1	2,500,000:1
Lamp Type	Laser	Laser	Laser	Laser
Keystone Correction (Standard Lens)	Vertical: ±3° / Horizontal: ±3°	Vertical: ±3° / Horizontal: ±3°	Vertical: ±3° / Horizontal: ±3°	Vertical: ±3° / Horizontal: ±3°

OPTICAL (for Standard Lens)

Zoom	1 – 1.35 (Digital)	1 – 1.35 (Digital)	1 – 1.35 (Digital)	1 – 1.35 (Digital)
Screen Size	65" to 100" @ 16:10	65" to 100" @ 16:9 60" to 110" @ 16:6	65" to 100" @ 16:9	65" to 100" @ 16:9 61" to 120" @ 16:6
Projection Distance	74.3" screen 0.44 m	76" screen at 0.44 m	80" screen 0.49 m	80" screen 0.49 m
Throw Ratio	0.28 (Zoom: Wide) 0.37 (Zoom: Tele)	0.26 (Zoom: Wide) 0.36 (Zoom: Tele)	0.27 (Zoom: Wide) / 0.37 (Zoom: Tele)	
Focus Method	Manual	Manual	Manual	Manual

CONNECTIVITY

Input: Video	1 x RCA (Yellow)	1 x RCA (Yellow)	1 x RCA (Yellow)	1 x RCA (Yellow)
Input: Computer	2 x RGB D-sub 15pin, 2 x USB 2.0 Type B			
Input: Digital	3 x HDMI	3 x HDMI	3 x HDMI	3 x HDMI, 1 x HDBaseT
Input: Audio	3 x Stereo mini, 1 x Mic-In Stereo Mini			
Control: I / O	1 x RS-232C D-sub 9pin, Interactive sync stereo mini - 1 x In / 1 x out, Touch Unit control - 1 x Min DIN 8pin			
Network: I / O	1 x RJ45, 1 x USB Type A			
Touch Interactive	Min DIN 8pin	Mini DIN 8pin	Min DIN 8pin	Min DIN 8pin
HDBaseT	-	-	-	Yes
Wireless Connectivity	Included	Included	Included	Included
Output: Video	1 x D-sub 15 pin (RGB)	1 x RGB D-sub 15pin	1 x D-sub 15pin (RGB), 1 x HDMI	1 x D-sub 15pin (RGB), 1 x HDMI
Output: Audio	1 x Stereo mini	1 x Stereo Mini	1 x Stereo mini	1 x Stereo mini

ADVANCED FEATURES

Built-in Speaker	16 W	16 W	2 x 8 W	2 x 8 W
Epson Projector Management (Network & Control)	Yes	Yes	Yes	Yes
Epson iProjection (Multi-PC Projection)	Yes	Yes	Yes	Yes
Interactivity	Pen Included, Finger Optional	Pen Included, Finger Optional	Pen Included, Finger Optional	Pen and Finger Included
Auto Screen Set Up	Yes	Yes	Yes	Yes
Control Pad	Optional (ELPCB03)	Optional (ELPCB03)	Optional (ELPCB03)	Included
Miracast	Yes	Yes	Yes	Yes
Wireless LAN	Yes	Yes	Yes	Yes
Finger Touch Unit (FTU)	Optional (ELPFT01)	Optional (ELPFT01)	Optional (ELPFT01)	Included
Split Screen	Yes	Yes	Yes	Yes
Edge Blending	-	-	-	Yes
Whiteboard Functioning	Yes	Yes	Yes	Yes
Super Resolution	Yes	Yes	Yes	Yes
Detail Enhancement	Yes	Yes	Yes	Yes
FTU Mount	Optional (ELPMB63)	Optional (ELPMB63)	Optional (ELPMB63)	Optional (ELPMB63)
Direct Power On / Off	Yes	Yes	Yes	Yes

Security Kensington® – style lock provision, Padlock Security cable hole, Wireless LAN unit lock, Password protect function

GENERAL

Dimensions D x W x H (Including Feet)	395 x 356 x 162 mm	395 x 356 x 162 mm	450 x 458 x 223.5 mm	450 x 458 x 223.5 mm
Weight	5.8 kg	5.8 kg	9.7 kg	9.7 kg
Projector Wall Mount	Optional (ELPMB62)	Optional (ELPMB62)	Optional (ELPMB62)	Included (ELPMB62)

*Pixel shifting technology achieves full HD resolution on screen

LARGE VENUE

Note: Highlighted boxes indicate step-ups between models / within series



EB-L520U

EB-L630U

EB-L730U

EB-L735U

EB-L630SU

EB-L635SU

Product Code

V11HA30053BU

V11HA26053BU

V11HA25053BU

V11HA25153BU

V11HA29053BU

V11HA29153BU

IMAGE

Light Source	Laser Diode	Laser Diode	Laser Diode	Laser Diode	Laser Diode	Laser Diode
Resolution	WUXGA	WUXGA	WUXGA	WUXGA	WUXGA	WUXGA
Colour Light Output	5,200 lm	6,200 lm	7,000 lm	7,000 lm	6,000 lm	6,000 lm
White Light Output	5,200 lm	6,200 lm	7,000 lm	7,000 lm	6,000 lm	6,000 lm
Native Aspect Ratio	16:10	16:10	16:10	16:10	16:10	16:10
Contrast Ratio	2,500,000:1	2,500,000:1	2,500,000:1	2,500,000:1	2,500,000:1	2,500,000:1
LD Input Power	185 W	219 W	236 W	236 W	211 W	211 W
Keystone Correction (Standard Lens)	Vertical: $\pm 30^\circ$ / Horizontal: $\pm 30^\circ$					
Lens Shift (Standard Lens)	Vertical: $\pm 50\%$ / Horizontal: $\pm 20\%$					

OPTICAL (for Standard Lens)

Zoom	1 – 1.6 (Optical)	1 – 1.6 (Optical)	1 – 1.6 (Optical)	1 – 1.6 (Optical)	1 – 1.35 (Digital)	1 – 1.35 (Digital)
Screen Size	50" to 500"	50" to 500"	50" to 500"	50" to 500"	50" to 200"	50" to 200"
Projection Distance	80" screen 2.33 m – 3.78 m				80" screen 1.38 m	80" screen 1.38 m
Throw Ratio	1.35 (Zoom: Wide) / 2.20 (Zoom: Tele)				0.80 (Zoom: Wide) / 1.07 (Zoom: Tele)	
Focus Method	Manual	Manual	Manual	Manual	Manual	Manual

CONNECTIVITY

Input: Computer	2 x D-sub 15-Pin (RGB), 1 x USB 2.0 type B					
Input: Digital	2 x HDMI, 1 x HDBaseT	2 x HDMI, 1 x HDBaseT	2 x HDMI, 1 x HDBaseT	2 x HDMI, 1 x HDBaseT	2 x HDMI, 1 x HDBaseT	2 x HDMI, 1 x HDBaseT
Input: Audio	2 x Stereo mini	2 x Stereo mini	2 x Stereo mini	2 x Stereo mini	2 x Stereo mini	2 x Stereo mini
Input Control: I/O	1 x RS-232C	1 x RS-232C	1 x RS-232C	1 x RS-232C	1 x RS-232C	1 x RS-232C
Network I / O	1 x RJ45, 1 x USB Type A (for optional Wireless LAN)*					
HDBaseT	Yes	Yes	Yes	Yes	Yes	Yes
Wireless Connectivity	Optional	Included	Included	Included	Included	Included
Output: Video	1 x D-sub 15-Pin (RGB)	1 x D-sub 15-Pin (RGB)	1 x D-sub 15-Pin (RGB)	1 x D-sub 15-Pin (RGB)	1 x D-sub 15-Pin (RGB)	1 x D-sub 15-Pin (RGB)
Output: Digital	-	1 x HDMI	1 x HDMI	1 x HDMI	1 x HDMI	1 x HDMI
Output: Audio	1 x Stereo mini	1 x Stereo mini	1 x Stereo mini	1 x Stereo mini	1 x Stereo mini	1 x Stereo mini

ADVANCED FEATURES

Built-in Speaker	10 W	10 W	10 W	10 W	10 W	10 W
Epson Projector Management (Network & Control)	Yes	Yes	Yes	Yes	Yes	Yes
Epson iProjection (Multi-PC Projection)	Yes	Yes	Yes	Yes	Yes	Yes
Epson Professional Tool	Yes	Yes	Yes	Yes	Yes	Yes
Epson Projector Content Manager	Yes	Yes	Yes	Yes	Yes	Yes
Wireless LAN Enterprise Security	Yes	Yes	Yes	Yes	Yes	Yes
Miracast	Yes	Yes	Yes	Yes	Yes	Yes
Split Screen	Yes	Yes	Yes	Yes	Yes	Yes
Super Resolution	Yes	Yes	Yes	Yes	Yes	Yes
Detail Enhancement	Yes	Yes	Yes	Yes	Yes	Yes
360 Degress Projection	Yes	Yes	Yes	Yes	Yes	Yes
Content Playback	Yes	Yes	Yes	Yes	Yes	Yes
Instant Off	Yes	Yes	Yes	Yes	Yes	Yes
Direct Power On	Yes	Yes	Yes	Yes	Yes	Yes
Security	Kensington® – style lock provision, Wireless LAN Unit Lock, Security cable hole					
Colour Modes	Dynamic, Presentation, Cinema, sRGB, DICOM SIM, Multi-Projection					

GENERAL

Dimensions D x W x H (Including Feet)	339 x 440 x 136 mm	339 x 440 x 136 mm	339 x 440 x 136 mm	339 x 440 x 136 mm	334 x 440 x 136 mm	334 x 440 x 136 mm
Weight	7.7 kg	8.4 kg	8.4 kg	8.4 kg	8.4 kg	8.4 kg
Power Consumption: LD On	293 W	345 W	345 W	345 W	345 W	345 W
Power Consumption: Standby	2 W	2 W	2 W	2 W	2 W	2 W
Noise Level (Normal / Eco)	31 / 23 dB	38 / 27 dB	38 / 27 dB	38 / 27 dB	38 / 27 dB	38 / 27 dB

*With an optional ELPAP11, it is possible to use the Miracast and WiFi function simultaneously (simple AP mode and manual mode)

LARGE VENUE

Note: Highlighted boxes indicate step-ups between models / within series



EB-PU1007WNL

EB-PU1008WNL

EB-PU1008BNL

EB-PU2010WNL

EB-PU2010BNL

Product Code

V11HA34953BU

V11HA33953BU

V11HA33853BU

V11HA52953BU

V11HA52853BU

IMAGE

Light Source	Laser Diode	Laser Diode	Laser Diode	Laser Diode	Laser Diode
Resolution	WUXGA	WUXGA	WUXGA	WUXGA	WUXGA
Colour Light Output	7,000 lm	8,500 lm	8,500 lm	10,000 lm	10,000 lm
White Light Output	7,000 lm	8,500 lm	8,500 lm	10,000 lm	10,000 lm
Native Aspect Ratio	16:10	16:10	16:10	16:10	16:10
Contrast Ratio	2,500,000:1	2,500,000:1	2,500,000:1	2,500,000:1	2,500,000:1
LD Input Power	291 W	372 W	372 W	388 W	388 W
Referenced Standard Lens	ELPLM08	ELPLM08	ELPLM08	ELPLM15	ELPLM15
Keystone Correction (Standard Lens)	Vertical: ±45° / Horizontal: ±30°				
Lens Shift (Standard Lens)	Vertical: ±67% / Horizontal: ±30%			Vertical: ±60% / Horizontal: ±18%	

OPTICAL (for Standard Lens)

Zoom	1 – 1.6 (Optical)	1 – 1.6 (Optical)	1 – 1.6 (Optical)	1 – 1.6 (Optical)	1 – 1.6 (Optical)
Screen Size	50" to 1000"	50" to 1000"	50" to 1000"	60" to 1000"	60" to 1000"
Projection Distance	100" screen 3.11 m – 5 m			100" screen 3.38 m – 5.52 m	
Throw Ratio	1.44 (Zoom: Wide) / 2.32 (Zoom: Tele)			1.57 (Zoom: Wide) / 2.56 (Zoom: Tele)	
Focus Method	Powered	Powered	Powered	Powered	Powered

CONNECTIVITY

Input: Computer	1 x D-sub 15-Pin (RGB)	1 x D-sub 15-Pin (RGB)	1 x D-sub 15-Pin (RGB)	1 x D-sub 15-Pin (RGB)	1 x D-sub 15-Pin (RGB)
Input: Digital	1 x HDMI, 1 x DVI-D, 1 x HDBaseT			1 x HDMI, 1 x DVI-D, 1 x HDBaseT	
Input: SDI	-	-	-	1 x BNC (3G-SDI)	1 x BNC (3G-SDI)
Control: I / O	1 x RS232C, 1 x Stereo mini	1 x RS232C, 1 x Stereo mini	1 x RS232C, 1 x Stereo mini	1 x RS232C, 1 x Stereo mini	1 x RS232C, 1 x Stereo mini
Network: I / O	1 x RJ45, 1 x USB Type A (for Optional Wireless LAN)				
HDBaseT	Yes	Yes	Yes	Yes	Yes
Wireless Connectivity	Optional	Optional	Optional	Optional	Optional
Output: Digital	-	-	-	1 x BNC (3G-SDI)	1 x BNC (3G-SDI)
Output: Audio	1 x Stereo mini	1 x Stereo mini	1 x Stereo mini	1 x Stereo mini	1 x Stereo mini

ADVANCED FEATURES

Epson Projector Management (Network & Control)	Yes	Yes	Yes	Yes	Yes
Epson iProjection (Multi-PC Projection)	Yes	Yes	Yes	Yes	Yes
Epson Professional Tool	Yes	Yes	Yes	Yes	Yes
Remote Access Camera	Yes (with Optional ELPEC01)	Yes (with Optional ELPEC01)	Yes (with Optional ELPEC01)	Yes (with Optional ELPEC01)	Yes (with Optional ELPEC01)
External Air Filter (High capacity)	Optional ELPAF63	Optional ELPAF63	Optional ELPAF63	Optional ELPAF63	Optional ELPAF63
Wireless LAN Enterprise Security	Yes (with Optional Wireless LAN Unit)				
4K Enhancement	Yes	Yes	Yes	Yes	Yes
Art-Net	Yes	Yes	Yes	Yes	Yes
Lens Position Memory	Yes (10 positions)	Yes (10 positions)	Yes (10 positions)	Yes (10 positions)	Yes (10 positions)
Split Screen	Yes	Yes	Yes	Yes	Yes
Edge Blending	Yes	Yes	Yes	Yes	Yes
Curved Screen Projection	Yes	Yes	Yes	Yes	Yes
Frame Interpolation	Yes	Yes	Yes	Yes	Yes
Super-resolution	Yes	Yes	Yes	Yes	Yes
Detail Enhancement	Yes	Yes	Yes	Yes	Yes
360 Degree Projection	Yes	Yes	Yes	Yes	Yes

Security	Kensington® – style lock provision, Wireless LAN Unit Lock, Security cable hole				
Colour Modes	Dynamic, Presentation, Cinema, BT.709, Natural, DICOM SIM, Multi-Projection				

GENERAL

Dimensions D x W x H (Including Feet)	436 x 545 x 189 mm	436 x 545 x 189 mm	436 x 545 x 189 mm	436 x 545 x 189 mm	436 x 545 x 189 mm
Weight	16.4 kg	16.4 kg	16.4 kg	17.0 kg	17.0 kg
Power Consumption: LD On	366 W	452 W	452 W	452 W	452 W
Noise Level (Normal/Eco)	34 / 30 dB	36 / 30 dB	36 / 30 dB	37 / 30 dB	37 / 30 dB

LARGE VENUE

Note: Highlighted boxes indicate step-ups between models / within series



EB-PU2213B

EB-PU2216B

EB-PU2220B

EB-L30000UNL

Product Code

V11HA68853BU

V11HA67853BU

V11HA66853BU

V11H944853BU

IMAGE

Light Source	Laser Diode	Laser Diode	Laser Diode	Laser Diode
Resolution	WUXGA	WUXGA	WUXGA	WUXGA
Colour Light Output	13,000 lm	16,000 lm	20,000 lm	30,000 lm
White Light Output	13,000 lm	16,000 lm	20,000 lm	30,000 lm
Native Aspect Ratio	16:10	16:10	16:10	16:10
Contrast Ratio	2,500,000:1	2,500,000:1	2,500,000:1	2,500,000:1
LD Input Power	562 W	746 W	934 W	1,670 W
Keystone Correction (Standard Lens)	Vertical: ±45° / Horizontal ±30°	Vertical: ±45° / Horizontal ±30°	Vertical: ±44° / Horizontal ±30°	Vertical: ±45° / Horizontal ±30°
Lens Shift (Standard Lens)	Vertical: ±60% / Horizontal: ±18%	Vertical: ±60% / Horizontal: ±18%	Vertical: ±60% / Horizontal: ±18%	Vertical: ±65% / Horizontal: ±30%

OPTICAL (for Standard Lens)

Zoom	1 – 1.6 (Optical)	1 – 1.6 (Optical)	1 – 1.6 (Optical)	1 – 1.35 (Optical)
Screen Size	60" to 1000"	60" to 1000"	60" to 1000"	100" to 1000"
Projection Distance	100" screen 3.37 m – 5.49 m	100" screen 3.37 m	100" screen 3.37 m	200" screen 7.48 m – 10.11 m
Throw Ratio	1.57 (Zoom: Wide) / 2.56 (Zoom: Tele)			1.74 (Zoom: Wide) 2.35 (Zoom: Tele)
Focus Method	Powered	Powered	Powered	Powered

CONNECTIVITY

Input: Video	-	-	-	1 x 5BNC
Input: Computer	1 x D-sub 15-Pin (RGB)	1 x D-sub 15-Pin (RGB)	1 x D-sub 15-Pin (RGB)	1 x D-sub 15-Pin (RGB)
Input: Digital	1 x HDMI, 1 x DVI-D, 1 x HDBaseT			1 x HDMI, 1 x DVI-D, 1 x HDBaseT
Input: SDI	1 x BNC (3G-SDI)	1 x BNC (3G-SDI)	1 x BNC (3G-SDI)	1 x BNC (3G-SDI)
Control: I / O	1 x RS232C, 1 x Stereo mini	1 x RS232C, 1 x Stereo mini	1 x RS232C, 1 x Stereo mini	1 x RS232C, 1 x Stereo mini
Network: I / O	1x RJ45 (Art-Net), 1 x USB Type A (for Optional Wireless LAN), 1 x USB Type B (service)			
HDBaseT	Yes	Yes	Yes	Yes
Wireless Connectivity	Optional	Optional	Optional	Optional
Output: Digital	1 x BNC (3G-SDI)	1 x BNC (3G-SDI)	1 x BNC (3G-SDI)	1 x BNC (3G-SDI)
Output: Audio	1 x Stereo mini	1 x Stereo mini	1 x Stereo mini	-

ADVANCED FEATURES

Epson Projector Management (Network & Control)	Yes	Yes	Yes	Yes
Epson Professional Tool	Yes	Yes	Yes	Yes
Remote Access Camera	Yes (with Optional ELPEC01)	Yes (with Optional ELPEC01)	Yes (with Optional ELPEC01)	Yes
Wireless LAN Enterprise Security	Yes (with Optional Wireless LAN Unit)	Yes (with Optional Wireless LAN Unit)	Yes (with Optional Wireless LAN Unit)	Yes (with Optional Wireless LAN Unit)
4K Enhancement	Yes	Yes	Yes	Yes
Fully Sealed Optical Engine	Yes	Yes	Yes	Yes
Art-Net	Yes	Yes	Yes	Yes
Lens Position Memory	Yes (10 positions)	Yes (10 positions)	Yes (10 positions)	Yes (10 positions)
Split Screen	Yes	Yes	Yes	Yes
Edge Blending	Yes	Yes	Yes	Yes
Scaling	Yes	Yes	Yes	Yes
Curved Screen Projection	Yes	Yes	Yes	Yes
Simple Stacking	Yes	Yes	Yes	Yes
NFC	Yes	Yes	Yes	-
Gamma Correction	Yes	Yes	Yes	Yes
Frame Interpolation	Yes	Yes	Yes	Yes
Super-resolution	Yes	Yes	Yes	Yes
Detail Enhancement	Yes	Yes	Yes	Yes
360 Degree Projection	Yes	Yes	Yes	Yes
Instant Off	Yes	Yes	Yes	Yes

LIGHTING		HOME THEATRE		
Note: Highlighted boxes indicate step-ups between models / within series				
	EV-110	EV-115	EH-TW5700	EH-TW7100
Product Code	V11HA22053	V11HA22153	V11HA12053	V11H959053
IMAGE				
Light Source	Laser Diode	Laser Diode	Lamp	Lamp
Resolution	WXGA	WXGA	1080p	4K Enhancement* (1920 x 1080 x 2)
Colour Light Output	2,200 lm	2,200 lm	2,700 lm	3,000 lm
White Light Output	2,200 lm	2,200 lm	2,700 lm	3,000 lm
Native Aspect Ratio	16:10	16:10	16:9	16:9
Contrast Ratio	2,500,000:1	2,500,000:1	35,000:1	100,000:1
Lamp Type	Laser	Laser	200 W UHE	250 W UHE
Keystone Correction (Standard Lens)	Vertical: ±45° Horizontal: ±40°	Vertical: ±45° Horizontal: ±40°	Vertical: ±30° Horizontal: ±30°	Vertical: ±30° Horizontal: ±30°
Lens Shift	-	-	-	Vertical: ±60% Horizontal: ±24%
Colour Processing	10-bit	10-bit	10-bit	10-bit
OPTICAL (for Standard Lens)				
Zoom	Total: 1 – 2.2 (Optical: 1 – 1.58, Digital: 1 – 1.4)		1 – 1.2 (Optical)	1 – 1.6 (Optical)
Screen Size	30" to 150"	30" to 150"	34" to 332"	40" to 500"
Projection Distance	60" screen 1.79 m	60" screen 1.79 m	80" screen 2.17 m – 2.61 m	100" screen 2.95 m – 4.77 m
Throw Ratio	1.38 (Zoom: Wide) / 2.19 (Zoom: Tele)		1.22 (Zoom: Wide), 1.47 (Zoom: Tele)	1.32 (Zoom: Wide) 2.15 (Zoom: Tele)
Focus Method	Powered	Powered	Manual	Manual
CONNECTIVITY				
Input: Digital	1 x HDMI	1 x HDMI	1 x HDMI	2 x HDMI
Input: SD Card	1 x SDHC, up to 32GB		-	-
USB: I / O	1 x USB type A zoom A (Power Supply)	1 x USB type A zoom A (Power Supply)	1 x USB mini B (service)	1 x USB Type A (Power Supply, Firmware Update), 1 x USB B mini (service)
Control	1 x USB type A for GPI	1 x USB type A for GPI	-	1 x RS232C, 1 x Stereo mini
Network: I / O	1 x RJ45	1 x RJ45	-	1 x USB Type A (for Optional Wireless LAN)
Wireless Connectivity	Included	Included	Included (via SMP)	Optional
Output: Audio	1 x Stereo mini	1 x Stereo mini	1 x Stereo mini	1 x Stereo mini
ADVANCED FEATURES				
Built-in Speaker	-	-	10 W	2 x 10 W
Epson Projector Management (Network & Control)	Yes	Yes	-	-
Detail Enhancement	-	-	Yes	Yes
4K Enhancement	-	-	-	Yes
Smart Media Player Included	-	-	Yes	-
Split Screen	-	-	Yes	Yes
Edge Blending	Yes	Yes	-	-
Frame Interpolation	-	-	Yes	Yes
360 Degree Projection	Yes	Yes	-	-
Content Playback Features	Playlists, Timetables (Scheduled Playlists), SD Viewer Movies (Motion, JPEG), Photos		-	-
Instant Off	Yes	Yes	Yes	Yes
Direct Power On	Yes	Yes	Yes	Yes
Security	Password Protect Function	Password Protect Function	Kensington – style lock provision	
Colour Modes	Dynamic, Normal	Dynamic, Normal	Dynamic, Bright Cinema, Natural, Cinema	
GENERAL				
Dimensions D x W x H (Including Feet)	Projection unit: 175 x D265 Power supply unit: 110 x 459 x 65 mm (with Cable Cover)		315 x 309 x 122 mm	330 x 410 x 164 mm
Weight	6.9 kg	6.9 kg	3.6 kg	6.9 kg
Lamp Life (Normal / Eco)	-	-	4,500 h / 7,500 h	3,500 h / 5,000 h
Power Consumption: Light Source On	170 W	170 W	297 W	406 W
Power Consumption: Standby	2.0 W	2.0 W	-	2.0 W

HOME THEATRE

Note: Highlighted boxes indicate step-ups between models / within series



EH-TW9400



EH-LS12000B



EH-LS300B



EH-LS500B

Product Code	V11H928053	V11HA47053	V11HA07153	V11H956653
--------------	------------	------------	------------	------------

IMAGE

Light Source	Lamp	Laser diode	Laser diode	Laser diode
Resolution	4K Enhancement* (1920 x 1080 x 2)	4K* (1920 x 1080) x 4	1080p	4K Enhancement* (1920 x 1080 x 2)
Colour Light Output	2,600 lm	2,700 lm	3,600 lm	4,000 lm
White Light Output	2,600 lm	2,700 lm	3,600 lm	4,000 lm
Native Aspect Ratio	16:9	16:9	16:9	16:9
Contrast Ratio	1,200,000:1	2,500,000:1	2,500,000:1	2,500,000:1
Lamp Type	250 W UHE	Laser	Laser	Laser
Keystone Correction (Standard Lens)	Vertical: ±30°	Vertical: ±30° Horizontal: ±30°	-	Vertical: ±3° Horizontal: ±3"
Lens Shift (Standard Lens)	Vertical: ±96.3% / Horizontal: ±47.1%	Vertical: ±96.3% / Horizontal: ±47.1%	-	-
Colour Processing	10-bit	10-bit	10-bit	10-bit
Advanced Image Processing	Yes	Yes (32-bit)	Yes	Yes

OPTICAL (for Standard Lens)

Zoom	1 – 2.1 (Optical)	1 - 2.1 (Optical)	-	1 – 1.35 (Digital)
Screen Size	50" to 300"	50" to 300"	61" to 120"	65" to 130"
Projection Distance	100" screen 3 m – 6.3 m	100" screen – 3 m – 6.3 m	75.9" screen 0.44 m	80" screen 0.5 m
Throw Ratio	1.35 (Zoom: Wide) 2.84 (Zoom: Tele)	1.35 (Zoom: Wide) 2.84 (Zoom: Tele)	0.26	0.28 (Zoom: Wide) 0.38 (Zoom: Tele)
Focus Method	Powered	Powered	Manual	Manual

CONNECTIVITY

Input: Computer	1 x D-sub 15-pin (RGB)	-	-	-
Input: Digital	2 x HDMI	2 x HDMI (HDCP2.3) (HDMI2 supports eARC/ARC)	2 x HDMI	3 x HDMI
USB: I / O	2 x USB Type A 1 x USB B mini (service)	2 x USB A (1x Opt. HDMI) 1 x USB B mini (service)	1 x USB Type A, 1 x USB B mini (service)	1 x USB Type A, 1 x USB B mini (service)
Control: I / O	1 x RS232C	1 x RS232C	-	1 x RS232C
Network: I / O	1 x RJ45, 1 x USB Type A (for Optional Wireless LAN)	1 x RJ45	1 x USB Type A	1 x RJ45, 1 x USB Type A (for Optional Wireless LAN)
Wireless Connectivity	Optional	-	Included	Included
Output: Audio	1 x Stereo mini	1 x Stereo mini	1 x S / PDIF	1 x HDMI (via HDMI2 only), 1 x Stereo mini

ADVANCED FEATURES

Built-in Speaker	-	-	20 W (2 x 2.1ch Satellite, 1 x Woofer)	2 x 10 W
Super Resolution	Yes	Yes (4K compatible)	-	Yes
High Dynamic Range - HDR10	Yes	Yes (HDR10+)	Yes	Yes
Hybrid Log Gamma - HLG	Yes	Yes	Yes	Yes
4K Enhancement*	Yes	Yes	-	Yes
Frame Interpolation	Yes	Yes (up to 4K 60fps)	-	Yes
Smart Media Player	-	Optional (ELPAP12)	Yes	Yes
Auto Contrast Enhancement	-	Yes	Yes	Yes
Scene Adaptive Gamma	-	Yes	Yes	Yes
Direct Power On	Yes	Yes	-	Yes
Security	Kensington® – style lock provision	Kensington®-style lock provision	Kensington® – style lock provision	Kensington® – style lock provision
Colour Modes	2D: Dynamic, Bright Cinema, Natural Cinema, Digital Cinema 3D: 3D Dynamic, 3D Cinema	Dynamic, Bright Cinema, Cinema, Natural, Vivid	Dynamic, Vivid, Bright Cinema, Cinema, Natural	Dynamic, Bright Cinema, Cinema, Game

GENERAL

Dimensions D x W x H (Including Feet)	450 x 520 x 192.7 mm	447 x 520 x 192.7 mm	400 x 467 x 149 mm	375 x 458 x 227.5 mm
Weight	11.2 kg	12.7 kg	7.2 kg	9.5 kg
Lamp Life (Normal / Eco)	3,500 h / 5,000 h	-	-	-

*4K Resolution Enhancement Technology shifts each pixel to produce an image on screen, up to the stated specification.

COLOUR LIGHT OUTPUT

KNOW YOUR PROJECTOR LUMENS



Brighter, vivid projection from Epson

WHAT IS COLOUR BRIGHTNESS?

Many people are in the dark about colour brightness. Of the numerous specifications to consider when purchasing a projector, this measure of colour light output is among the most important.

COLOUR BRIGHTNESS

is a scientifically set global standard that measures a projector's Colour Light Output. This measure is crucial to gauge the performance of a projector.

LOW COLOUR BRIGHTNESS

HIGH COLOUR BRIGHTNESS

Low Colour Brightness can result in images that are 1/3 as bright!

COLOUR BRIGHTNESS COUNTS

Colour is the keystone of any memorable presentation, increasing memory significantly over monochromatic visuals

86% of presentations contain colour

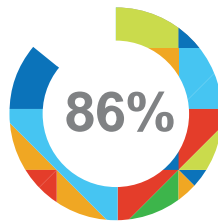

Colours at peak brightness and saturation attract the most attention

97% of consumers agree that brightness is a key component of image quality

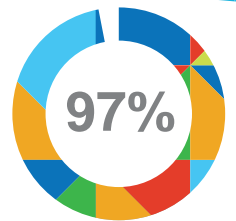

3LCD TECHNOLOGY

Not All Projectors Are Created Equal. Using 3LCD technology means that you don't have to sacrifice the vibrancy of rich multimedia by projecting a single colour at a time.



EPSON CoverPlus SERVICE PACK OPTIONS

RETURN TO BASE

Epson CoverPlus SERVICE PACK

These service packs offer repair by an Epson Authorised Service Agent, with the cost of all parts and labour covered.

This is available as either a 1, 2, or 3 year option.



RAPID EXCHANGE

Epson CoverPlus SERVICE PACK

With this service pack, a faulty product can be exchanged with a functional equivalent product the next day.

5 year Rapid Exchange cover is available with selected models.

ON-SITE

Epson CoverPlus SERVICE PACK

Enjoy on-site repair of your product by an Epson Authorised Service Agent.

This pack is available with selected high-end projector models.



Please contact your dealer about **Epson CoverPlus** today.

Terms and conditions apply. For more information visit: www.epson.com.au/shoponline/coverplus

Epson CoverPlus

Fast. Reliable. Professional

OPTIONAL LENSES

EB-L30000U								
Lens type	Rear Projection	Wide Zoom	Wide Zoom	Mid Throw	Mid Throw	Mid Throw	Long Throw	Long Throw
Reference	ELPLR05	ELPLU05	ELPLW07	ELPLM12	ELPLM13	ELPLM14	ELPLL09	ELPLL10
Order Number	V12H004X0A	V12H004X0B	V12H004W07	V12H004M0D	V12H004M0E	V12H004L09	V12H004R05	V12H004R05
Throw Ratio	0.63	0.90 – 1.09	1.29 – 1.76	1.74 – 2.35	2.28 – 3.46	3.41 – 5.11	4.79 – 7.20	6.73 – 10.45

EB-PU Series												
Lens type	Ultra-short-throw	Ultra-short-throw	Short throw	Short throw	Wide Throw	Wide Throw	Wide Throw	Mid Throw	Mid Throw	Mid Throw	Mid Throw	Long Throw
Reference	ELPLX01S	ELPLX02S	ELPLU03S	ELPLU04	ELPLW05	ELPLW06	ELPLW08	ELPLM08	ELPLM15	ELPLM10	ELPLM11	ELPLL08
Order Number	V12H004X01	V12H004X02	V12H004UA3	V12H004U04	V12H004W05	V12H004W06	V12H004W08	V12H004M08	V12H004M08	V12H004M0A	V12H004M0B	V12H004L08
Throw Ratio	0.35:1	-	0.65 – 0.78:1	0.87 – 1.06:1	1.04 – 1.46:1	1.63 – 2.22:1	1.18 – 1.66:1	1.45 – 2.32:1	2.15 – 3.49:1	3.31 – 5.07:1	4.48 – 7.39:1	7.2 – 10.12:1
PU2213B / PU2216B / PU2220B	-	0.35:1	0.48 – 0.57:1	0.64 – 0.78:1	-	1.19 – 1.63:1	0.86 – 1.21:1	-	1.58 – 2.56:1	2.43 – 3.71:1	3.54 – 5.41:1	5.27 – 7.41:1

OPTIONS AND ACCESSORIES

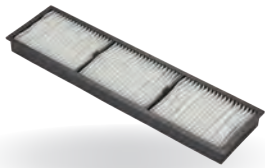

Air Filters

Regularly replace the air filter in your Epson projector in order to maintain image quality and to ensure longevity.



Lamps

Order genuine Epson lamps to ensure that you achieve the best possible image quality and colour reproduction.



Speakers

Enhance the audio experience with the Epson ELP-SP02 powered speaker set.



Control Pad

A simple cable management solution from Epson. Ideal for classrooms and meeting spaces.

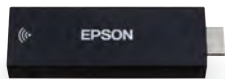

Streaming Media Player

Stream your favourite content with the ELPAP12.



Portable Screen

Epson portable, light weight 80 inch screen is the perfect display solution for your home or office.



Ceiling Mounts

Ceiling mounts to suit all models of Epson projectors.



Wireless LAN Adapter

A simple yet powerful solution to enabling wireless connectivity to your Epson projector (optional models only).

Epson is the registered trademark of Seiko Epson Corporation. All other names and company names used herein are for identification purpose only and may be the trademarks or registered trademarks of their respective owners. Epson disclaims any and all rights in those marks. All print samples shown herein are simulations. Specifications are subject to change without notice.

Better Products for a Better Future™

EPSON AUSTRALIA

Level 1, 3 Talavera Road
Macquarie Park NSW 2113
Tel: (02) 8899 3666
www.epson.com.au

EPSON NEW ZEALAND

Level 2, 7-9 Fanshawe Street
Auckland, 1010
Tel: (09) 366 6855
www.epson.co.nz

ABN 91 002 625 783

09/22

EPSON
EXCEED YOUR VISION